

STATE OF OREGON
COUNTY OF CLACKAMAS
CERTIFICATE OF WATER RIGHT

THIS CERTIFICATE ISSUED TO

CRAIG ZIELINSKI
10290 SOUTH TOWNSHIP ROAD
CANBY, OREGON 97013

confirms the right to use the waters of A WELL in the MOLALLA RIVER BASIN for the purpose of IRRIGATING 24.9 ACRES.

The right has been perfected under Permit G-9576. The date of priority is JUNE 4, 1981. The right is limited to not more than 0.31 CUBIC FOOT PER SECOND or its equivalent in case of rotation, measured at the well.

The well is located as follows:

NE 1/4 NW 1/4, SECTION 2, T 4 S, R 1 E, W.M.; 1190 FEET SOUTH AND 1350 FEET EAST FROM THE NW CORNER OF SECTION 2.

The amount of water used for irrigation, together with the amount secured under any other right existing for the same lands, shall be limited to ONE-EIGHTIETH of one cubic foot per second per acre, or its equivalent for each acre irrigated and shall be further limited to a diversion of not to exceed 2.5 acre-feet per acre for each acre irrigated during the irrigation season of each year.

The right shall conform to such reasonable rotation system as may be ordered by the proper state officer.

A description of the place of use under the right, and to which such right is appurtenant, is as follows:

NE 1/4 NW 1/4 14.2 ACRES
SE 1/4 NW 1/4 10.7 ACRES
SECTION 2
TOWNSHIP 4 SOUTH, RANGE 1 EAST, W.M.

The right to the use of the water for the above purpose is restricted to beneficial use on the lands or place of use described.

WITNESS the signature of the Water Resources Director, affixed this date OCTOBER 24, 1989.

/s/ WILLIAM H. YOUNG

Water Resources Director

Recorded in State Record of Water Right Certificates numbered 62493

G-10362.JW

T.3&4S., R.1E. W.M.

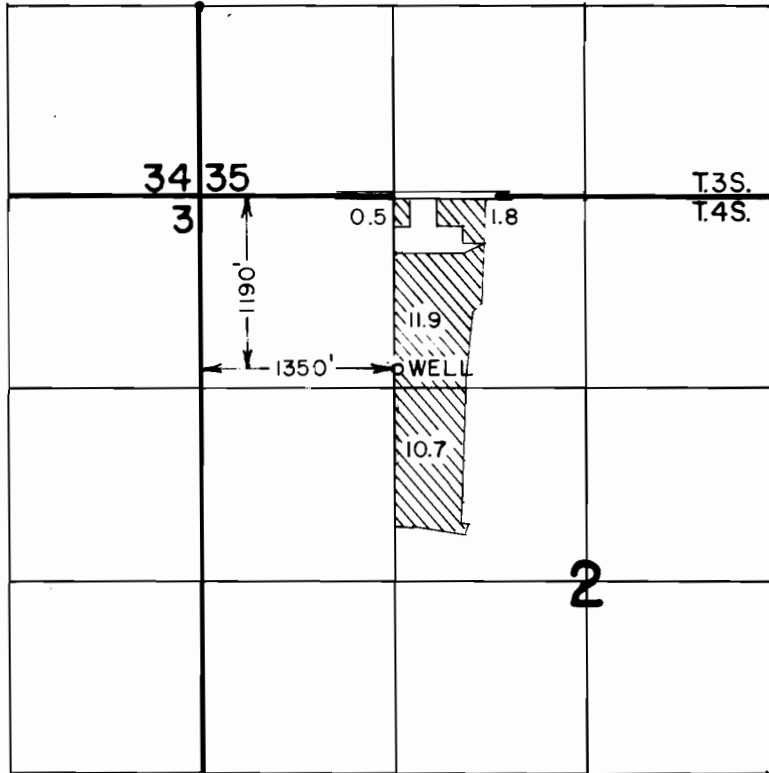

FINAL PROOF SURVEY UNDER

Application No. G-10362 Permit No. G-9576
IN NAME OF

CRAIG ZIELINSKI

Surveyed JUNE 30 1986, by T. WARREN



T. 3 & 4 S., R. 1 E., W.M.

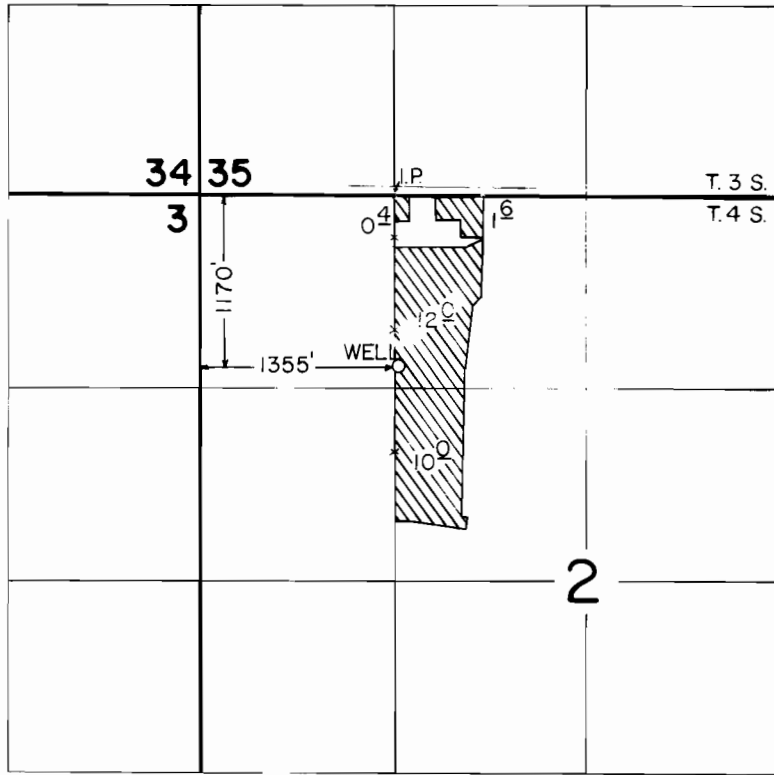

Handwritten notes:
 1. 0.25' x 1.0' land
 2. 0.25' x 1.0' land

SCALE: 1" = 1320'

FINAL PROOF SURVEY UNDER

Application No. G-10362 Permit No. G-9576

IN NAME OF

CRAIG ZIELINSKI

Surveyed JUNE 30 1986, by T. WARREN